



Regional Policy Issues

Joe Flanagan

Head of Energy and Environmental Technologies

NWDA – What we do

- **Our purpose is to build the region's competitiveness and build the region's economy**
 - Business Support
 - Encouraging investment into the region
 - Developing priority industry sectors
 - Developing skills for the future
- **Regional Strategy 2010**

UK Energy Policy Drivers

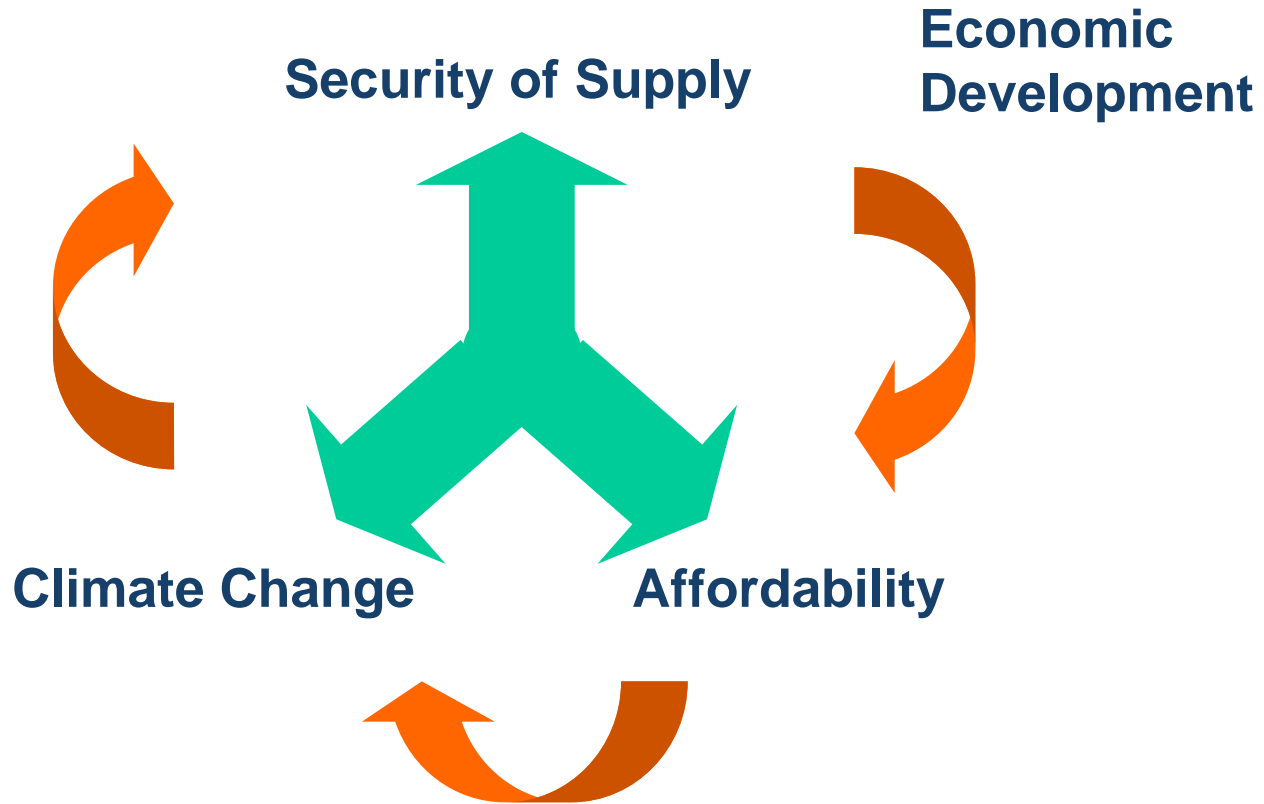

Regional Policy Themes

- **Climate change**
 - Mitigation and adaptation
- **Sustainable Consumption and Production**
 - Understanding the issues and assisting businesses with resource efficiency
- **Sector Development for Energy and Environmental Technologies**
 - Exploiting the economic opportunities

'Rising to the Challenge'

- The Vision - 'A Low Carbon and Well Adapted Northwest by 2020'
- Transformational Action 24 within the Regional Economic Strategy.
- Launched in October 2006 by the Northwest Climate Change Partnership.
- 27 Actions to help reduce the region's emissions, adapt to climate change and develop a low carbon economy
- £30m of investment into projects including Climate Challenge Fund

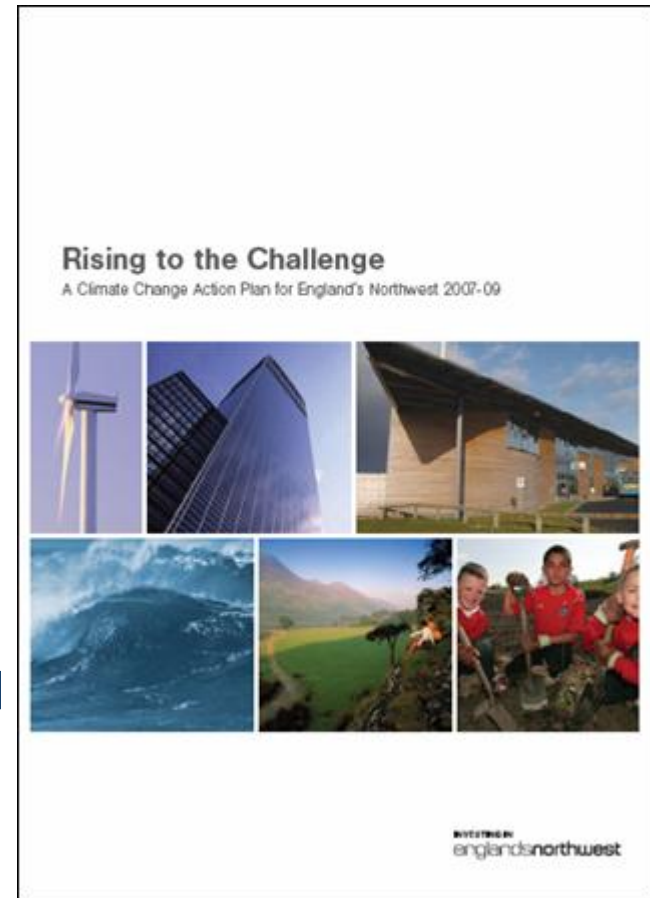

Structure for CCAP Actions

Approach evolves over time as attitudes and behaviour change

Enable

- Develop evidence base
- Provide skills & education
- Scope regional risks, opportunities and priorities
- Promote best practice

Encourage

- Reduce up-front costs
- Pledge initiatives
- Incentivise change
- Introduce climate proofing criteria

Catalyse

- Ensure positive policy & planning framework
- Develop regional low-carbon fund
- Support environmental technology, knowledge and service sectors

Engage

- Community engagement
- Develop regional and sub-regional partnerships and agencies
- Influence national policy
- Implement climate change communications strategy

Exemplify

- Instigate carbon reduction and adaptation measures in the public sector
- Undertake demonstration projects
- Ensure regional strategies prioritise low-carbon energy and climate change adaptation

CCAP Projects and Programmes

- **Capacity & Communications**
- **Research**
- **Transport & Domestic**
- **Education & Skills**
- **Demonstration Funds**
 - **Northwest Climate Fund - Foundation**
 - **Grant to Improve Your Resource Efficiency**
 - **'Ringfenced' Grant for Research and Development**
 - **Carbon Challenge Fund**

Research

- **NW GHG Inventory 2005 (4NW)**
- **Measures to reduce NW Carbon Emissions by 2020 - The Wedges (4NW)**
- **Impact on Key Sectors (public and private) by ARUP.**
- **Future Aviation Scenarios with the Tyndell Centre.**
- **Biodiversity Impacts Research with Natural England.**
- **Business and General Public Perceptions Study.**
- **Economic costs from EA flood risk assessment by URS.**
- **Skills challenges for a low carbon economy by Ecotec.**
- **Role of Green Infrastructure with Community Forests NW and University of Manchester (through the GRaBs Interreg Project)**

Progress - highlights

- **Creating ‘Grant for Improving your Resource Efficiency’.**
- **Increased allocation within Grant for Research and Development for low carbon technologies.**
- **Foundation – A Climate Fund for the Northwest.**
- **Carbon Challenge Fund launched.**
- **Low Carbon Market Development Programme launched.**
- **Biomass Programme launched**
- **Establishment of Energy Saving Trust Advice Centres.**
- **Local Authority Support Programme (CLASP) has become national best practice.**
- **Bespoke climate change work programmes in each Sub-Region.**

CCAP Demonstration

- **Grants to SME's delivered through NWDA Finance for Business.**
<http://www.nwdabusinessfinance.co.uk>
 - Ringfenced **GRAND** allocation of £2m for next two years - to develop and demonstrate low carbon technologies.
 - **Grant to Improve Your Resource Efficiency** allocation of £4m for next 2 years to install low-carbon technologies.
- **Carbon Challenge Fund.**
 - Low carbon projects which demonstrate the 'art of the possible' sourced through open competition. £2.5m over next two years NWDA funding only.
- **Demonstration Support Programme**
 - Funding coordination and database for projects in public and private sector.
 - Hands on advice a support to maximise awareness and access to external funding sources.

Low Carbon Market Development

- **£1.2M over 3 years.**
- **Technical expertise to assist with delivery of renewable and low carbon energy capacity.**
- **Replacement for Renewables NW and CLAREN delivered through Envirolink NW.**
- **Core Team plus Sub-Regional officers, including Greater Manchester.**

Foundation

- Delivered by Groundwork NW in Manchester.
- £1.6M investment approved to kick-start the NWCF.
- Carbon compensation fund for NW organisations and individuals – unlock investment in low carbon technologies and practices.
- Aims to fund cost effective carbon reduction activities – sequestration, energy efficiency, renewables, etc.
- Sustainable fund, and potential for sub-regional branding/focus.
- Maximum £50,000 per project.
- Launched 16th April 2009.
- <http://foundation.climatefund.org.uk>

Sustainable Consumption and Production

- **Vision to ‘achieve more with less – a more productive, resource-efficient, low carbon North West by 2020’**
 - Smarter consumption
 - Rethink design
 - Sustainable production
 - Waste as a resource
 - Thriving Environmental Technology and Services Sector
- **Projects and programmes**
 - ENWORKS Business Resource Efficiency
 - NW Eco-Innovation Project
 - NW Sustainable Construction Knowledge Hub
 - Sub Regional Demonstrations

Getting Results

Our Work

Rec

Recognition

ENWORKS has won awards and been recognised as best practice by a

- **Funding ~£8.7m**
- **Outputs, results and impacts (actual 08/09)**
 - **1470 businesses assisted with resource efficiency**
 - **68,160 tonnes of material saved**
 - **108,920 tonnes of carbon dioxide saved**
 - **1,598,980m3 of water saved**
 - **61,950 tonnes of waste diverted from landfill**
 - **235 jobs created or safeguarded**

Regeneration
& Renewal
AWARDS 2007
WINNER



RELATED RESOURCES

- Reducing Carbon Impact and Improving Business Competitiveness Film
News Date: 17/11/09
- ENWORKS receives £9.9 million new investment
News Date: 5/11/09
- ENWORKS evaluation - Full report
Date Created: 1/06/08 / PDF / 845.8K
- National eWell-Being Awards 2007
Date Created: 4/07/07 / PDF / 496.2K

- Highly Commended for the Regeneration and Renewal Awards (2007) - in category 'Environmentally sustainable regeneration scheme of the Year'

NW Eco-Innovation Project

- **Assisting businesses to develop products and services which have reduced environmental impact by virtue of their design, raw materials, manufacture, use, application, reuse and disposal**
- **Funding ~£3.5 million, delivered by Lancaster University and C-tech Innovation Ltd**
- **Outputs, results and impacts (forecast)**
 - 480 Jobs created/safeguarded
 - 480 Businesses assisted
 - 160 Business improving their performance
 - 240 New environmental products
 - 12,000 tonnes Carbon dioxide saved



Search: Go

NW Construction Knowledge

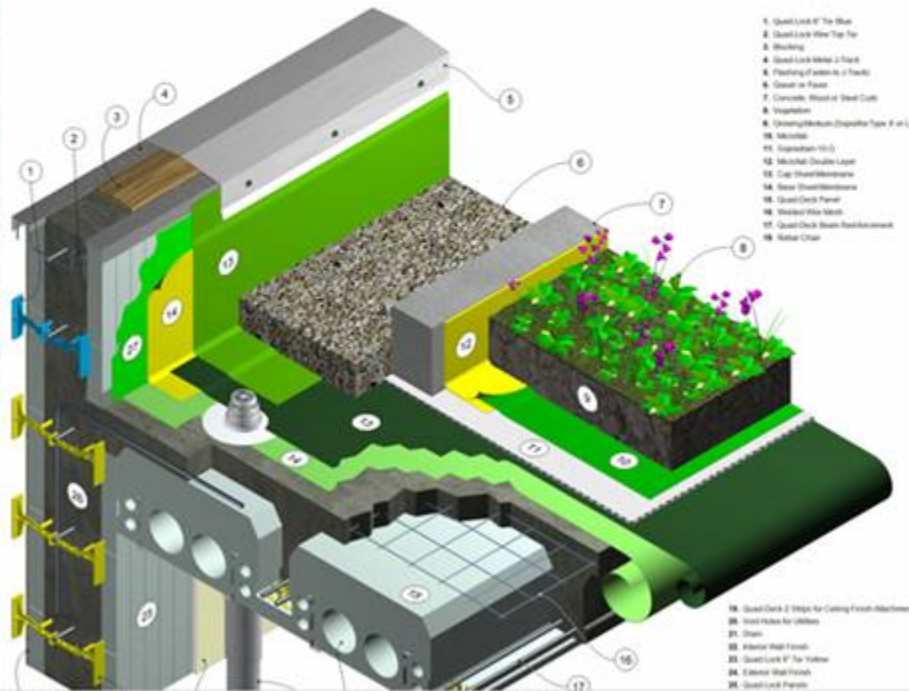

NW Construction Knowledge Hub

The North West Construction Knowledge Hub
less carbon, less waste, more jobs

This project is to give small construction firms in the North West the knowledge to better manage their carbon and waste impacts.

Small firms need this knowledge to win more work, make buildings greener, create new jobs, and play their part in our journey to a new, low-carbon prosperous economy.

The North West Construction Knowledge Hub is a three-year project funded by the EU (European Regional Development Fund) and the Northwest Regional Development Agency (NWDA) to assist small and medium construction companies in the region to improve their resource efficiency. Our strapline is: less carbon, less waste, more jobs.

This project will assist 200 small and medium-sized firms, safeguard 300 jobs and help create a further 300 jobs in the North West. The project is lead by the Centre for Construction Innovation within the University of Salford, with our four partner organisations at the University of Central Lancashire, the University of Liverpool, Urban Vision Ltd and the national Building Research Establishment

Sector Development

- **Innovation**

- The Joule Centre for Energy Research
- Energy Innovation Centre
- GRAND – Grants for Research and Development
- Innovation Vouchers

- **Business Support**

- Business Link
- Envirolink Northwest and other cluster organisations
- High Growth Programme
- Business Finance

- **Internationalisation**

- Trade and FDI

Priority sectors

- **Electricity Networks/Smart Grids**
- **Offshore wind and tidal energy**
- **Energy Efficiency and Building Technologies**
- **Nuclear – New Build**

Search

News Sections

Renewables

Hydropower

Wind

Solar

General renewables

Tidal

Wave

Energy Supply

Networks

Demand Reduction

Lighting

Low Carbon Building

Leadership and Debate

Events and Conferences

Reports and Papers

Major Challenges

Skills

Social Issues

Funding

R&D

Updated: Fri, 27 Nov 2009 16:23:18



Trade associations support "socialised" grid access model

Friday, 27 November 2009

In response to the Government's consultation on improving grid access, two major industry groups have come out in favour of sharing constraint costs for renew

[Full Story](#)



Renewables Advisory Board questions feed-in tariff plans

The Renewables Advisory Board (RAB) has responded to...

[Full Story](#)



China and the USA commit to COP15 emissions targets

The United States and China have revealed emissions re...

[Full Story](#)



Government names its first Chief Construction Adviser

Paul Morrell OBE has been appointed to the new role of...

[Full Story](#)



Marine and Coastal Access Act set to streamline offshore wind planning

The Marine and Coastal Access Bill has received Royal ...

[Full Story](#)

The News Centre

Welcome to the Joule Centre's energy news briefing microsite. Visit us regularly for the latest comment, opinion and analysis from the Joule team on the regional and international energy scene.

Joule Featured Article



Joule helps facilitate £8m collaborative marine energy project

A new £8 million research project to make marine energy more competitive in the marketplace is set to make use of the Joule Centre's wave and tidal test facility.

[Full Story](#)

Sign up for our newsletter

The Joule Centre for Energy Research

- £5.3m over 5 years
- Network of energy researchers from Northwest Universities
- Provides grants and supports energy research which involved industrial collaboration

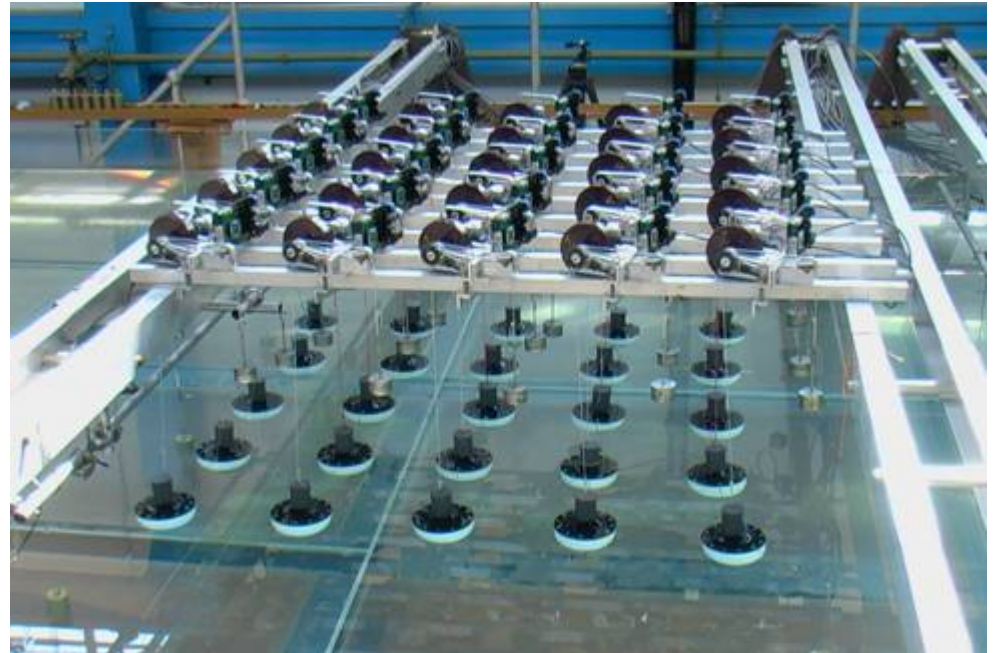

Energy Innovation Centre

- **NWDA have invested £1.6m**
- **Energy Companies**
 - Scottish Power
 - Scottish and Southern Energy
 - Electricity Northwest
 - CE Electric
- **Equity Investment Fund**
- **Aims to help grow and develop businesses in the Energy Sector.**

Energy Innovation Centre

Latest News

Speeches and Transcripts

Statements and Articles

Prime Minister's Questions

Press Briefings

Press Notices

Webchats

November 2009

M	T	W	T	F	S	S
						1
2	3	4	5	6	7	8
9	10	11	12	13	14	15
16	17	18	19	20	21	22
23	24	25	26	27	28	29
30						

« Oct

Thursday 5 November 2009

PM visits north Wales and the North West

The Prime Minister has visited Airbus UK's manufacturing facility in the north Wales town of Broughton today.

Gordon Brown visited the site, which is being extended to help meet orders for the new A350 - the fastest selling passenger aircraft of all time.

The PM told workers and apprentices that the investment made in Airbus in the last few months is important for securing the future of the company.

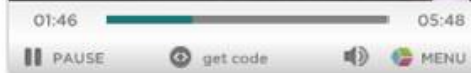

"We are determined that this is and remains the biggest manufacturing facility in the United Kingdom.

At the same time, where small and medium-sized firms are finding it difficult with cash flow, thousands have benefited from the schemes that we have set up."

He said the government was working to maintain the number of apprenticeships and to increase young people going to college and university.

"Any young person who has left school in the last few months has been

Sign up to our newsletter to keep updated with the latest information from Number 10

[Click here to subscribe](#)

Around the Web

flickr



Latest Photos



[View all images](#)

Share this:

YouTube



Latest Videos



Reliability of Supply and Network Efficiency



Micro storage technologies

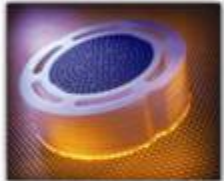

Fuel cell technologies
courtesy of Ceramic Fuel Cells



Loss of mains protection



New green energy solutions



New asset management solutions



Headspace tester for oil filled HV equipment



Cable oil sniffer



Tap changer monitoring



Portable asset management data gathering



Energy Efficiency



Micro CHP



NEW ENERGY SAVING SOLUTIONS



Domestic voltage regulation



Smart metering solutions



Green Plug - demand responsive domestic plug

Renewable & Low Emission Energy

Envirolink Northwest

- **Helps develop and grow the Environmental Technologies Sector in the region**
- **Includes programme for wind energy supply chain companies**
- **Support Activities**
 - One to one advice to companies
 - Helping to overcome barriers to deployment
 - Networking and industry events
 - Trade promotion
 - Assistance with R&D and development of products and services

Wind Supply Chain Support

- **Supply Chain Directory**
- **Trade Fairs and trade promotion**
- **Technical advice and assistance**
- **Northern Wind Innovation Programme**



NW Nuclear

- **Half of the UK's Civil Nuclear workforce**
- **4 possible sites for new build**
- **Strong centre for R&D**
- **Many major Tier 1 and 2 co.s located in the region.**

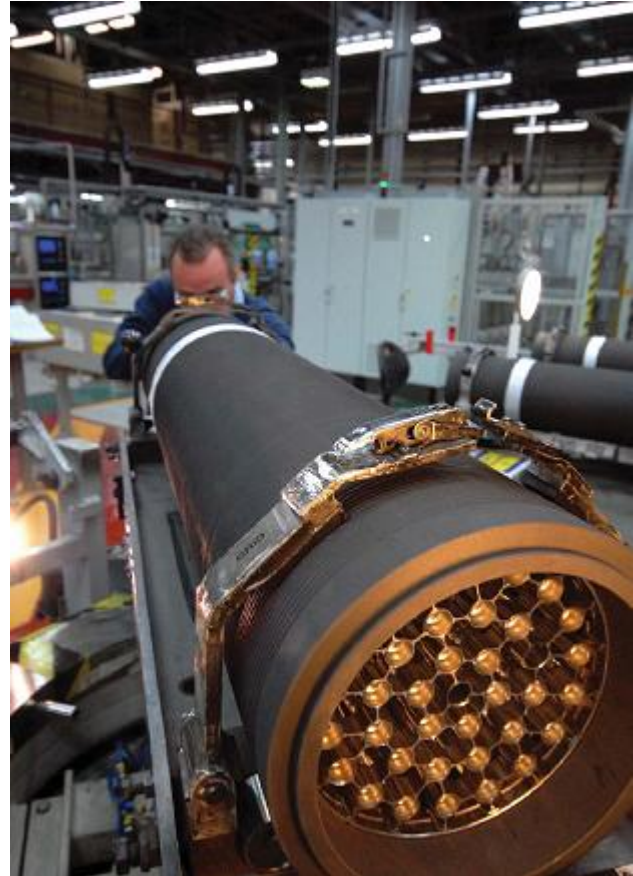

Current NW generation capacity

①	British Energy, Heysham,	2400 MW
②	Scot. & Southern F.-Ferry	2000 MW
③	Dong Barrow,	90 MW
④	Dong Burbo Bank	90 MW
⑤	Robin Rigg	180 MW
⑥	Peel, Scout Moor	66 MW
<hr/>		4826 MW
	Industrial CHP	755 MW
	Onshore wind	260 MW
	Landfill/sewage gas	83 MW
	Onshore wind	58 MW
	Hydro	1 MW
<hr/>		1157 MW

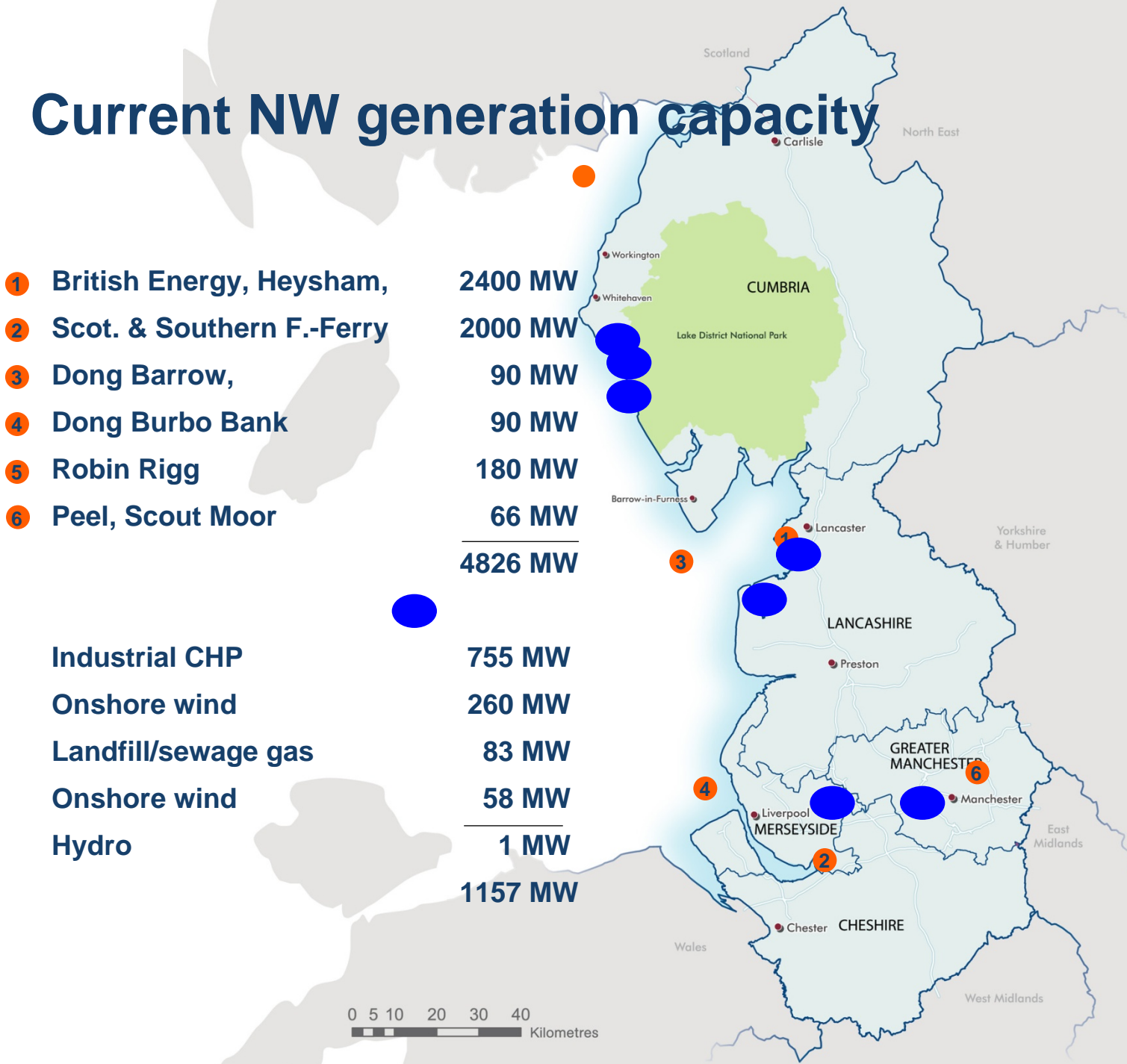
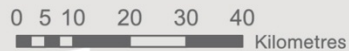

Conclusions

- **Energy and climate change are complex policy areas**
- **Major changes to energy supply and consumption can be expected due to**
 - Rising prices
 - Climate Change policy drivers
- **The NWDA is leading regional policy development**
- **Policies and programmes will**
 - Address climate change mitigation and adaptation
 - Support economic development